

Specifications

Cat.5e RJ45 plug, 2 pairs
Qualified Screened Class D
ISO/IEC 11801 2.2 Edition
IEC 60603-7-51
CENELEC EN 50173-1:2011

Electrical

Current Rating: 1.5 Amps Maximum.
Contact Resistance: 20 mOhm Maximum. at 100 mA max. 50 mV max.
Insulation Resistance: 500 MOhm Minimum. at 500V DC
Dielectric Withstanding Voltage: 1000 V AC RMS 60 Hz, 1 minute.

Mechanical

Durability: 1000 mating cycles.
Cable to Plug Tensile Strength: 20 lbs (89N) min.
Temperature: -40° C to 70° C

Physicals

Plastic: High Impact Flame Retardant Plastic,
UL 94V-0 Rated
Plug-Contact: T=0.35mm Phosphor Bronze,
Contact Area: Gold Over Nickel Plating.
IDC-Contact: T=0.4mm Phosphor Bronze, Sn over Nickel Plating.
Shielded-Base: T=0.5mm Brass, Nickel Plating.
Shielded-Cover: T=0.3mm Phosphor Bronze, Nickel Plating.
Accept Cable: #23~22AWG Solid Wire. Outer diameter 6.0~8.5

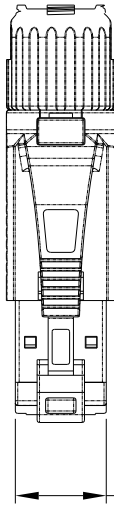
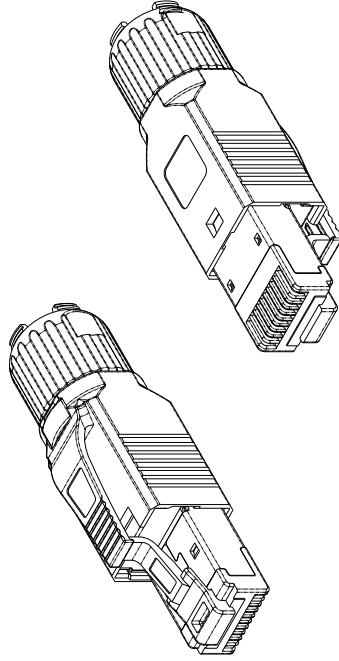

11.70±0.10

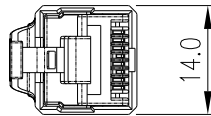

14.0

53.7(ref.)

16.4

13.50

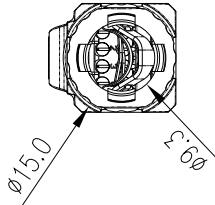

ø15.0

ø9.3

Shielded-Cover

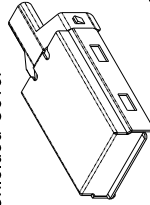

Wire-Manager (Two Pair)
for 22~23 AWG



Color Icon



Nut

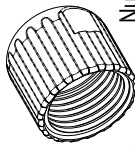

SR Housing

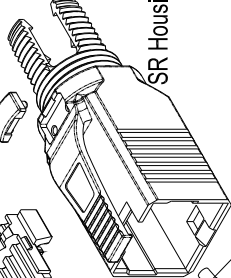

Cable Spring Cleat

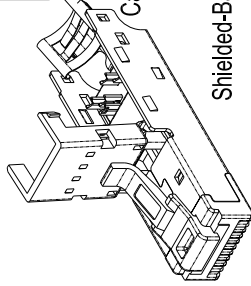

Shielded-Base

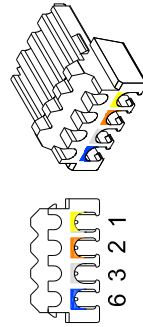

PROFINET COLOR CODE



Date	2017 / 06 / 07
Unit	mm
Projection	
Rev	A

Title:	Keystone Mounting for enclosures
Item no.	86465
Barcode	4043619864652
File No.	