



## Installation Guide

87659

### Appearance

Front and Rear View

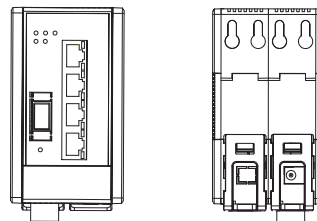

Left and Right View

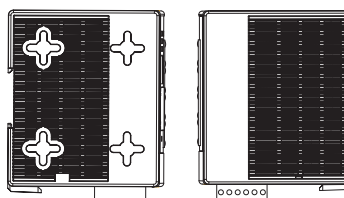

Top and Bottom View



### DIN rail mounting

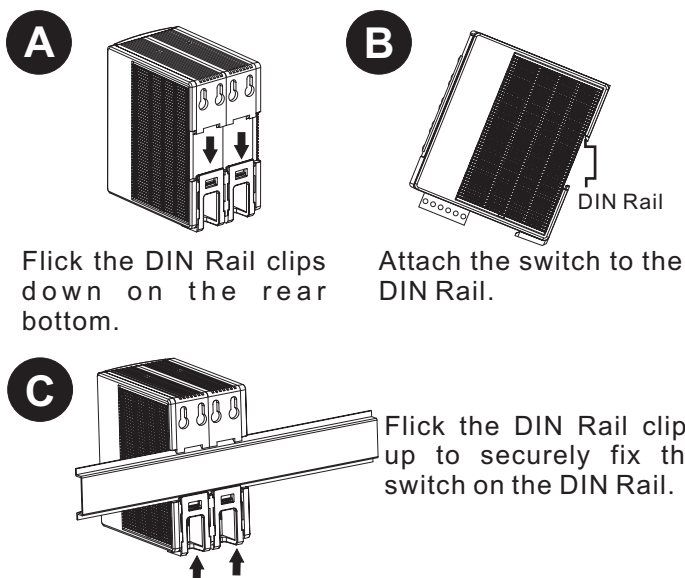

### Wall mounting (lateral)

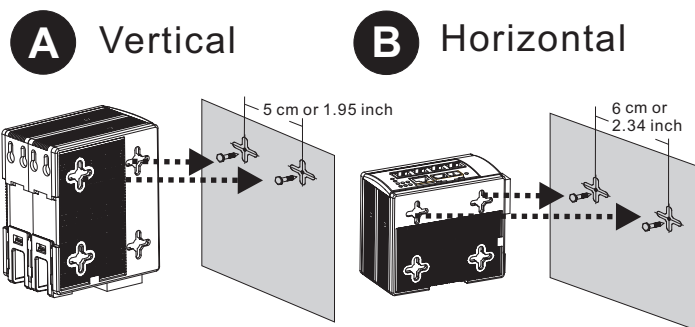

1. Screw two bolts into the wall. The distance between them should be 5 cm (1.95 inch) for vertical hanging, and 6 cm (2.34 inch) for horizontal hanging.
2. Hang the switch on the wall.

### Wall mounting (rear)

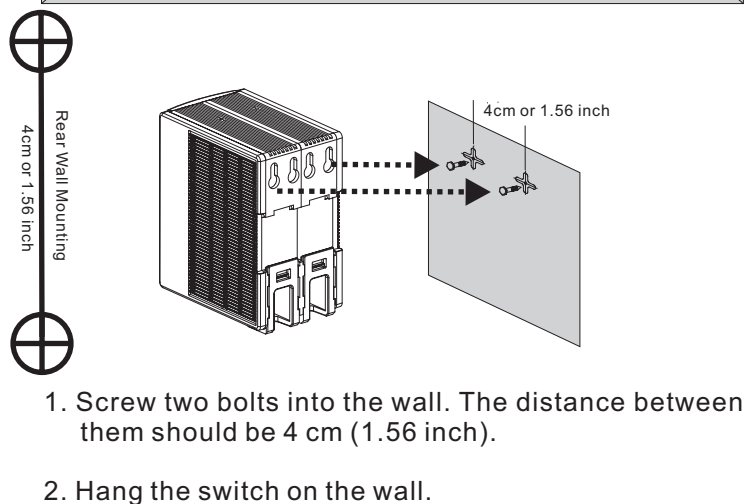

### Connection

